

MIR60-Uni

Activation + Safety

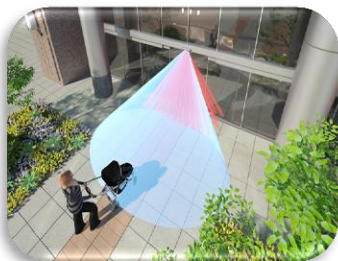

Elegant, user friendly and reliable activation sensor with pedestrian safety zone



Hybrid (microwave activation and infrared safety) sensor with a dual relay

- Preserves Energy Loss**
 Robust and fully adjustable antenna allows timely activation Uni directional mode allows door to close quickly, thus safe up to 6% on heating or air condition
- Easy change of settings**
 3-digit menu for quick adjustment of all settings
- Ideal for any automatic sliding door**
 MIR60 provides reliable activation plus safety to the best market standards.
- Quick Installation**
 Due to fully adjustable antenna with two detection modes (wide or narrow) and digital menu, sensor installs in minutes.

MIR60-UNI

Activation + Safety



Technical Data:

Accessories:



Model	MIR60 activation & safety (EN165005)
Detection Method	Microwave 24.125GHz (activation) plus Active Infrared (safety)
Installation Height	2000 - 3000mm (max.)
Presence Timer	2s, 30s, 60s, ∞
LED indicator	Green: Standby Blue: Motion detection (activation) Red: Safety/Presence Detection Green + Red: Low Reflection!
Power Supply	AC/DC 12V to 24V ±10% (50 - 60MHz)
Power Consumption	AC12V: 300mA (max); AC24V: 200mA (max.) DC12V: 160mA (max.) DC24V: 80mA (max.)
Output	Relay: 1A / 24V DC Photo MOS: Max. Voltage 400V, Max. Current: 120mA, Max. Internal resistance 35Ω
Test Input	6[mA] at 24V DC
Response Time	0.1s (radar), 0.2s (infrared)
Work Temperatures	-20°C to +60°C
IP Class	54
Weight	250g
Colour	MIR60/BL (black)
Dimensions	265mm (W) x 60mm (H) x 42.5mm (D)

Detection Zone [m]

